

**Port sizes G¹/₄ - G1
and ¹/₄NPT - ¹/₂NPT**

- **Sub-bases toVDMA 24 345 specification, for ISO sizes #1, #2, #3 and #4**
- **Universal bases for ISO sizes #1 and #2, side and bottom ported**



Technical Data

Medium:

See individual valve details.

Mounting:

Through-holes in sub-base, threaded.

Port Sizes:

G¹/₄ ISO#1

G³/₈ ISO#2

G¹/₂ ISO#3

G³/₄ ISO#4

Operating Pressure:

16 bar (232 psig) for VDMA bases

10 bar (145 psig) for Universal bases

Operating Temperature:

-15°C to +80°C (5°F to +176°F) for VDMA bases

-15°C to +50°C (5°F to +122°F) for Universal bases

Materials:

Diecast aluminium, steel cap head screws and nuts,
nitrile rubber seals.

Ordering Information

To order select model number, e.g. M/P19137 for the Bottom Ported ISO#3 Single Station Sub-base.

For VDMA 24 345 Sub-bases, quote the required number of bases together with one End Plate Assembly per island, e.g. 5 off CQM/22253/3/21 together with 1 off CQM/22253/3/22 for a 5 station valve island.

For Universal Sub-bases, quote the required number of bases together with two Single End Plates per island, e.g. 5 off CQM/22152/3/27 with 1 off CQM/22152/3/28 and 1 off CQM/22152/3/31 for a 5 station valve island.

All Sub-bases and End Plates are supplied complete with the appropriate seals, nuts and bolts. The interface gaskets and body to base fixing bolts are supplied with individual valve bodies.

For technical data on ISO 5599-1 interface valve ranges see following sections:

ISO★STAR 5.4.185

AUTO★STAR 5.4.186

UM/22000 5.4.171

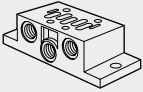
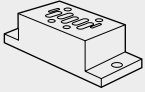
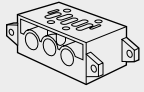
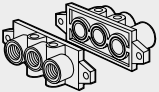
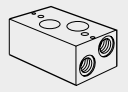

VDMA 24 345 Base Range, G-ported version

VDMA 24 345	Form 'A'	Form 'B'	Form 'C'	Form 'D'	Form 'E'
					
	Single Station Sub-base Side Ported	Single Station Sub-base Bottom Ported	Modular Sub-base Bottom Ported ¹⁾	Modular Sub-base End Plates (2)	Directional Cylinder Port Device (90°)
ISO #1 models	M/P19126	M/P19125	CQM/22152/3/21	CQM/22152/3/22	FP 8361
ISO #2 models	M/P19132	M/P19131	CQM/22253/3/21	CQM/22253/3/22	FP 8461
ISO #3 models	M/P19138	M/P19137	CQM/22354/3/21	CQM/22354/3/22	FP 8561
ISO #4 models	M/P19144	M/P19143	CQM/22456/3/21	CQM/22456/3/22	FP 8661

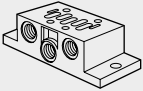
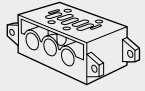
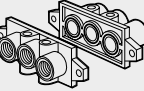

¹⁾ Pilot ports on side

VDMA 24 345 Base Range, NPT-ported version

VDMA 24 345	Form 'A'	Form 'C'	Form 'D'
			
	Single Station Sub-base Side Ported	Modular Sub-base Bottom Ported ¹⁾	Modular Sub-base End Plates (2)
ISO #1 models	C/P19126	CQC/22152/3/21	CQC/22152/3/22
ISO #2 models	C/P19132	CQC/22253/3/21	CQC/22253/3/22
ISO #3 models	C/P19138	CQC/22354/3/21	CQC/22354/3/22

¹⁾ Pilot ports on side

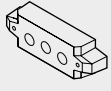
Accessories to VDMA 24 345 Base Range

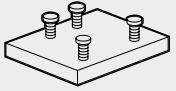
			
	Transition plate	Blanking disk ²⁾	Blanking Platte ³⁾
ISO #1 models	CQM/22152/3/24 #1→#2	FP 8382	CQM/22152/3/23
ISO #2 models	CQM/22253/3/24 #2→#3	FP 8482	CQM/22253/3/23
ISO #3 models	CQM/22354/3/24 #3→#4	FP 8582	CQM/22354/3/23
ISO #3 models	CQM/22354/3/32 #3→#1	—	CQM/22456/3/23

²⁾ For Multipressure systems

³⁾ Can be used on Universal base too.

Overview

Model	Type	ISO Size	Port Size	Pilot Port Size	Weight kg (lb.)
M/P19126	Single Station Sub-base Side Ported	#1	G1/4	G1/8	0.16 (0.35)
M/P19132	Single Station Sub-base Side Ported	#2	G3/8	G1/8	0.28 (0.62)
M/P19138	Single Station Sub-base Side Ported	#3	G1/2	G1/8	0.36 (0.79)
M/P19144	Single Station Sub-base Side Ported	#4	G3/4	G1/8	0.98 (2.16)
C/P19126	Single Station Sub-base Side Ported	#1	NPT1/4	NPT1/8	0.16 (0.35)
C/P19132	Single Station Sub-base Side Ported	#2	NPT3/8	NPT1/8	0.28 (0.62)
C/P19138	Single Station Sub-base Side Ported	#3	NPT1/2	NPT1/8	0.36 (0.79)
M/P19125	Single Station Sub-base Bottom Ported	#1	G1/4	G1/8	0.19 (0.42)
M/P19131	Single Station Sub-base Bottom Ported	#2	G3/8	G1/8	0.32 (0.70)
M/P19137	Single Station Sub-base Bottom Ported	#3	G1/2	G1/8	0.40 (0.88)
M/P19143	Single Station Sub-base Bottom Ported	#4	G3/4	G1/8	0.72 (1.58)
CQM/22152/3/21	Modular Sub-base Bottom Ported	#1	G1/4	G1/8	0.24 (0.53)
CQM/22253/3/21	Modular Sub-base Bottom Ported	#2	G3/8	G1/8	0.36 (0.79)
CQM/22354/3/21	Modular Sub-base Bottom Ported	#3	G1/2	G1/8	0.72 (1.58)
CQM/22456/3/21	Modular Sub-base Bottom Ported	#4	G3/4	G1/8	1.40 (3.08)
CQC/22152/3/21	Modular Sub-base Bottom Ported	#1	NPT1/4	NPT1/8	0.24 (0.53)
CQC/22253/3/21	Modular Sub-base Bottom Ported	#2	NPT3/8	NPT1/8	0.36 (0.79)
CQC/22354/3/21	Modular Sub-base Bottom Ported	#3	NPT1/2	NPT1/8	0.72 (1.58)
CQM/22152/3/22	Modular Sub-base End Plates (2)	#1	G3/8	—	0.22 (0.48)
CQM/22253/3/22	Modular Sub-base End Plates (2)	#2	G1/2	—	0.34 (0.75)
CQM/22354/3/22	Modular Sub-base End Plates (2)	#3	G1	—	0.66 (1.45)
CQM/22456/3/22	Modular Sub-base End Plates (2)	#4	G1	—	1.30 (2.86)
CQC/22152/3/22	Modular Sub-base End Plates (2)	#1	NPT3/8	—	0.22 (0.48)
CQC/22253/3/22	Modular Sub-base End Plates (2)	#2	NPT1/2	—	0.34 (0.75)
CQC/22354/3/22	Modular Sub-base End Plates (2)	#3	NPT1	—	0.66 (1.45)

For dimensions and drawings see next page.



VDMA 24 345 Sub-base Options

Single Station Sub-base Side Ported (Form 'A')

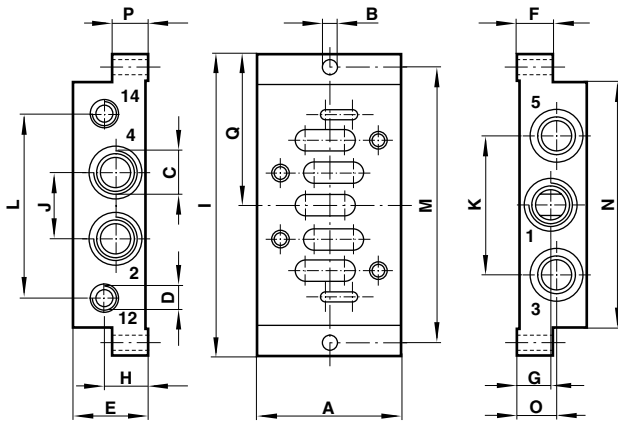

Dimension	*P19126 ISO#1	*P19132 ISO#2	*P19138 ISO#3	M/P19144 ISO#4
A	48 (1,88)	57 (2,28)	71 (2,84)	85 (3,40)
B	5,5 (0,22)	6 (0,24)	6,6 (0,264)	9 (0,36)
C	1/4 (G or NPT)	3/8 (G or NPT)	1/2 (G or NPT)	G ³ / ₄
D	1/8 (G or NPT)	1/8 (G or NPT)	1/8 (G or NPT)	G ¹ / ₈
E	32 (1,28)	40 (1,60)	32 (1,28)	42 (1,68)
F	10 (0,40)	13 (0,52)	18 (0,72)	19 (0,76)
G	11,3 (0,42)	14 (0,56)	17 (0,68)	19 (0,76)
H	23,5 (0,94)	30 (1,20)	22 (0,88)	30 (1,20)
I	110 (4,40)	124 (4,96)	149 (5,96)	186 (7,44)
J	24 (0,96)	30 (1,20)	32 (1,28)	42 (1,68)
K	43 (1,72)	56 (2,24)	68 (2,72)	90 (3,60)
L	58 (2,32)	74 (2,96)	90 (3,60)	111 (4,44)
M	98 (3,92)	112 (4,48)	136 (5,44)	170 (6,80)
N	84 (3,36)	95 (3,80)	119 (4,76)	148 (5,92)
O	21,5 (0,85)	26 (1,02)	17 (0,67)	22 (0,88)
P	11,5 (0,45)	14 (0,55)	17 (0,67)	22 (0,88)
Q	55 (2,16)	62 (2,44)	74,5 (2,93)	99,5 (3,91)

* Insert 'M' for G-ported version or 'C' for NPT-ported version.

Single Station Sub-base Bottom Ported (Form 'B')

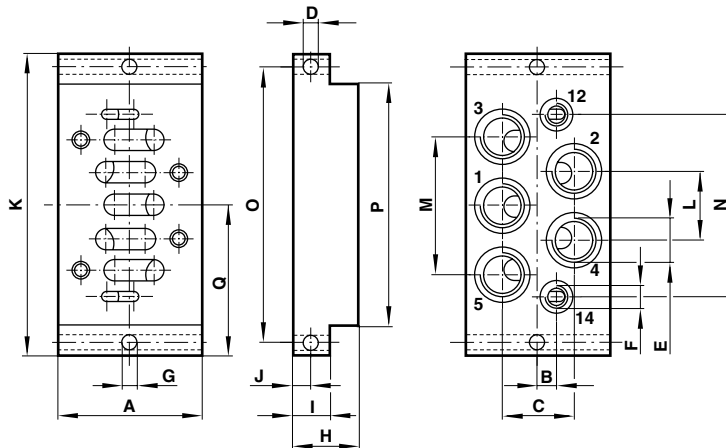

Dimension	M/P19125 ISO#1	M/P19131 ISO#2	M/P19137 ISO#3	M/P19143 ISO#4
A	46 (1,84)	56 (2,28)	71 (2,48)	85 (3,40)
B	7 (0,28)	8 (0,32)	10 (0,40)	15 (0,60)
C	23 (0,92)	27 (1,08)	34 (1,36)	40 (1,60)
D	5,5 (0,22)	6,6 (0,26)	6,6 (0,26)	9 (0,36)
E	G ¹ / ₄	G ³ / ₈	G ¹ / ₂	G ³ / ₄
F	G ¹ / ₈	G ¹ / ₈	G ¹ / ₈	G ¹ / ₈
G	5,5 (0,22)	6,6 (0,24)	6,6 (0,26)	9 (0,30)
H	30 (1,20)	35 (1,40)	32 (1,28)	28 (1,12)
I	10 (0,40)	13 (0,52)	18 (0,72)	19 (0,76)
J	5 (0,20)	6,5 (0,24)	9 (0,36)	9,5 (0,38)
K	110 (4,40)	124 (4,96)	149 (5,96)	186 (7,44)
L	24 (0,88)	28 (1,12)	34 (1,36)	45 (1,80)
M	46 (1,84)	56 (2,24)	68 (2,72)	90 (3,60)
N	62 (2,48)	73 (2,96)	90 (3,60)	111 (4,44)
O	98 (3,92)	112 (4,48)	136 (5,44)	170 (6,80)
P	84 (3,36)	95 (3,80)	119 (4,76)	148 (5,92)
Q	55 (2,16)	62 (2,44)	74,5 (2,93)	99,5 (3,91)

Modular Sub-bases and End Plates (Form 'C' and 'D')

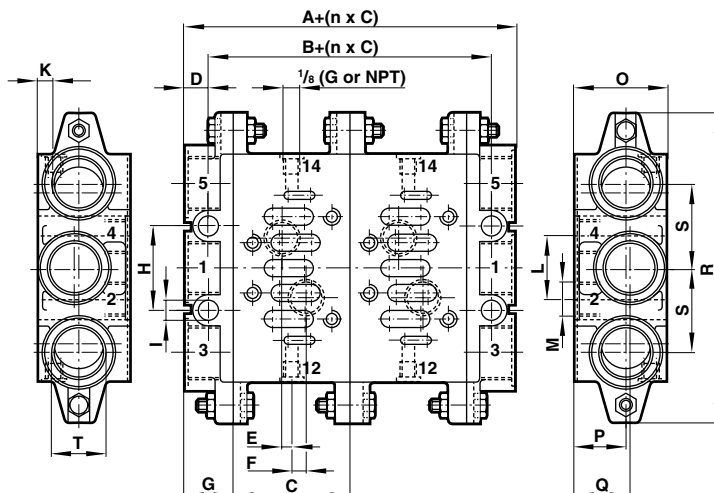

Sub-base	CQ*/22152/3/21	CQ*/22253/3/21	CQ*/22354/3/21	CQM/22456/3/21
End Plates	CQ*/22152/3/22	CQ*/22253/3/22	CQ*/22354/3/22	CQM/22456/3/22
Dimension	ISO#1	ISO#2	ISO#3	ISO#4
A	44 (1,76)	52 (2,08)	60 (2,40)	60 (2,40)
B	22 (0,88)	26 (1,04)	30 (1,20)	30 (1,20)
C	43 (1,72)	56 (2,28)	71 (2,84)	82 (3,28)
D	11 (0,44)	13 (0,52)	15 (0,60)	15 (0,60)
E	1,5 (0,06)	5 (0,20)	6 (0,24)	8 (0,32)
F	7,5 (0,30)	6 (0,24)	8 (0,32)	9 (0,36)
G	22 (0,88)	26 (1,04)	30 (1,20)	30 (1,20)
H	28 (1,12)	35 (1,40)	52 (2,08)	56 (2,28)
I	7 (0,28)	9 (0,36)	12 (0,48)	12 (0,48)
K	8,5 (0,34)	9 (0,36)	10 (0,40)	10 (0,40)
L	26 (1,04)	30 (1,20)	38 (1,52)	52 (2,05)
M	1/4 (G or NPT)	3/8 (G or NPT)	1/2 (G or NPT)	3/4 (G or NPT)
O	46 (1,84)	47 (1,88)	56 (2,24)	58 (2,32)
P	21 (0,84)	22 (0,88)	31 (1,22)	28 (1,12)
Q	24 (0,96)	24 (0,96)	34 (1,36)	28 (1,12)
R	110 (4,40)	135 (5,40)	190 (7,60)	215 (8,60)
S	28 (1,12)	34 (1,36)	52 (2,08)	54 (2,16)
T	3/8 (G or NPT)	1/2 (G or NPT)	1 (G or NPT)	G1

* Insert 'M' for G-ported version or 'C' for NPT-ported version

Inclusive of screws, nuts, washers and O-Rings.

All dimensions in mm (inch)!



Directional Cylinder Port Device (Form E)

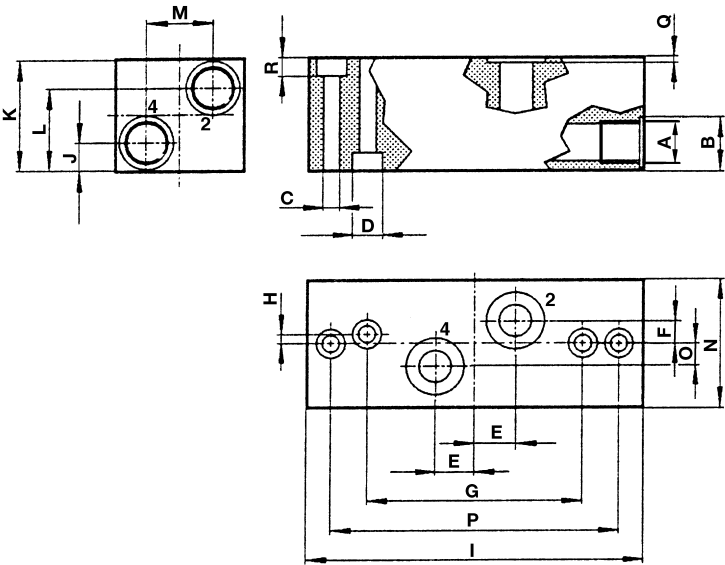

Model No.	FP8361	FP8461	FP8591	FP8661
Dimension	ISO#1	ISO#2	ISO#3	ISO#4
A	G ¹ / ₄	G ³ / ₈	G ¹ / ₂	G ³ / ₄
B	19 (0,74)	23 (0,89)	27 (1,05)	33 (1,28)
C	5,5 (0,21)	6,6 (0,24)	9 (0,35)	9 (0,35)
D	10 (0,39)	11 (0,42)	15 (0,58)	15 (0,58)
E	13 (0,50)	15 (0,58)	19 (0,74)	26 (1,01)
F	7,5 (0,30)	6 (0,22)	8 (0,31)	9 (0,35)
G	71 (2,76)	86 (3,35)	130 (5,07)	142 (5,53)
H	3 (0,11)	3 (0,11)	3 (0,11)	3 (0,11)
I	110 (4,29)	135 (5,26)	190 (7,41)	215 (8,38)
J	12 (0,46)	14 (0,54)	17 (0,66)	23 (0,89)
K	37 (1,44)	40 (1,56)	45 (1,75)	65 (2,53)
L	25 (0,97)	26 (1,01)	29 (1,13)	44 (1,71)
M	22 (0,85)	29 (1,13)	36 (1,42)	41 (1,60)
N	42 (1,64)	55 (2,14)	70 (2,73)	80 (3,12)
O	1,5 (0,06)	5 (0,19)	6 (0,22)	8 (0,31)
P	95 (3,70)	115 (4,48)	168 (6,55)	184 (7,16)
Q	1,4 (0,05)	1,4 (0,05)	1,4 (0,05)	1,4 (0,05)
R	5,7 (0,22)	6,8 (0,26)	9 (0,35)	9 (0,35)
Weight				
kg (lb.)	0.35 (0.77)	0.70 (1.44)	1.40 (2.88)	2.60 (5.73)

Inclusive of screws and O-Rings.

Transition Plate

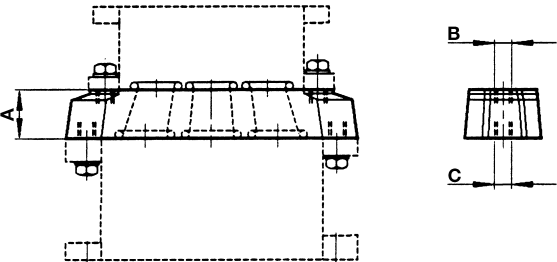



Model No.	CQM/22152/3/24	CQM/22253/3/24	CQM/22354/3/24	CQM/22354/3/32
Dimension	ISO#1 → #2	ISO#2 → #3	ISO#3 → #4	ISO#3 → #1
A	25 (0,97)	40 (1,56)	40 (1,56)	34 (1,36)
B	M5	M6	M8	M5
C	M6	M8	M10	M8
Weight				
kg (lb.)	0.35 (0.77)	0.65 (1.42)	0.90 (1.98)	0.60 (1.323)

Inclusive of screws, washers and O-Rings.

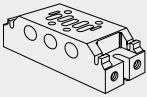
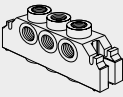
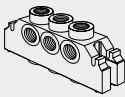
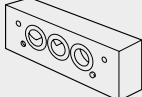

Universal Base Range

					
	Modular Sub-base Side and Bottom Ported	Single End Plate All Ports closed	Single End Plate End Ports open	Transition Plate	Blanking Disk
ISO #1 models	CQM/22152/3/27	CQM/22152/3/28	CQM/22152/3/31	CQM/22152/3/29 #1→#2	M/P43173
ISO #2 models	CQM/22253/3/27	CQM/22253/3/28	CQM/22253/3/31		M/P43174

Modular Sub-base

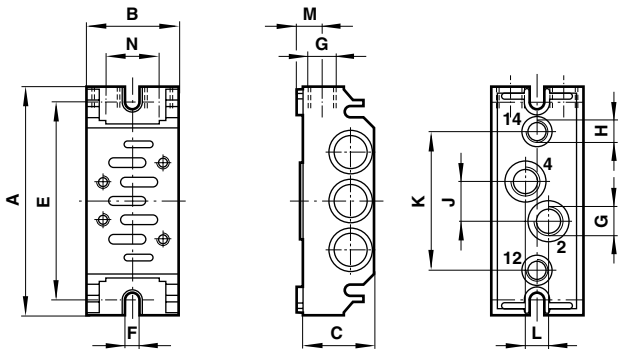

Side and Bottom Ports.
Pilot ports on bottom.

Inclusive of screws, nuts, washers, O-rings and two plugs for ports 2 + 4.

Model	ISO Size	A	B	C	E	F	G	H	J	K	L	M	N	Weight kg (lb.)
CQM/22152/3/27	#1	106 (4,24)	43 (1,72)	36 (1,44)	92 (3,68)	5,5 (0,22)	G1/4	G1/8	18 (0,72)	64 (2,56)	11,5 (0,45)	12 (0,48)	23 (0,90)	0.16 (0.35)
CQM/22253/3/27	#2	120 (4,80)	56 (2,24)	46 (1,84)	102 (0,48)	6,5 (0,26)	G3/8	G1/8	24 (0,96)	68 (2,72)	19 (0,76)	15 (0,60)	29 (1,14)	0.35 (0.77)

Single End Plates

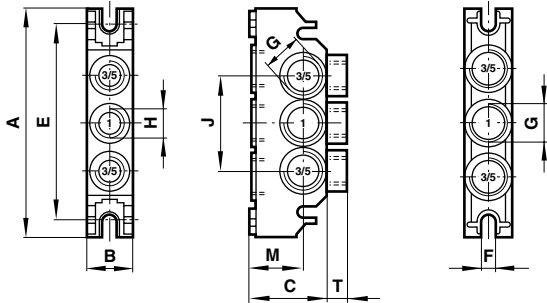

Model	Connections
CQM/22152/3/28, CQM/22253/3/28	All ports closed
CQM/22152/3/31, CQM/22253/3/31	End Ports open

Connections can be in end, bottom or top.

Drill dimension for opening the ports:

- ø 8 mm drill for G¹/₄ port
- ø 15 mm drill for G³/₈ port
- ø 15 mm drill for G¹/₂ port

Inclusive of screws, nuts, washers and O-rings.

Note: These End Plates can also be used as Intermediate Supply and Exhaust Modules!

Model	ISO Size	A	B	C	E	F	G	H	J	M	T	Weight kg (lb.)
CQM/22152/3/28, CQM/22152/3/31	#1	106 (4,24)	22 (0,88)	36 (1,44)	92 (3,68)	5,5 (0,22)	G3/8	G1/4	44 (1,76)	25 (1,00)	9 (0,36)	0.13 (0.28)
CQM/22253/3/28, CQM/22253/3/31	#2	120 (4,80)	29 (1,16)	46 (1,84)	102 (4,08)	6,5 (0,26)	G1/2	G1/4	58 (2,32)	31 (1,24)	7 (0,28)	0.23 (0.50)

Transition Plate ISO #1 → #2

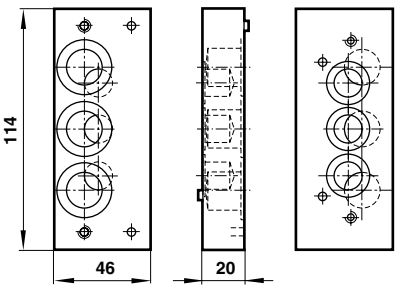

Model	Weight kg (lb.)
CQM/22152/3/29	0.23 (0.50)

Inclusive of screws, nuts, washers and O-rings!

Blanking Plate

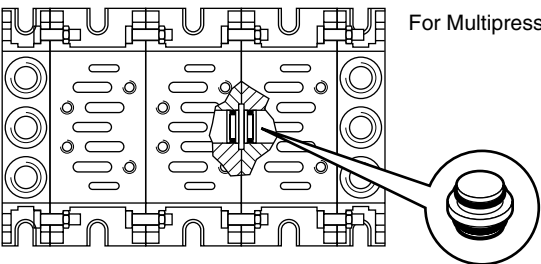

Model	ISO Size	Weight kg (lb.)
M/P43173	#1	0.01 (0.02)
M/P43174	#2	0.03 (0.06)

All dimensions in mm (inch)!



Warning

These products are intended for use in industrial compressed air systems only. Do not use these products where *pressures* and *temperatures* can exceed those listed under '**Technical Data**'.

Before using these products with fluids other than those specified, for non-industrial applications, life-support systems, or other applications not within published specifications, consult NORGREN.

Through misuse, age, or malfunction, components used in fluid power systems can fail in various modes. The system designer is warned to consider the failure modes of all component parts used in fluid power systems and to provide adequate safeguards to prevent personal injury or damage to equipment in the event of such failure.

System designers must provide a warning to end users in the system instructional manual if protection against a failure mode cannot be adequately provided.

System designers and end users are cautioned to review specific warnings found in instruction sheets packed and shipped with these products where applicable.
